

# CONTOIL® VZD / VZP and DFM Consumption measurement

## Applications

Fuel consumption measurement for trucks, buses, trains, construction and agricultural machinery, small boats and generators.



## Features

- Quick and easy installation in vehicles of every type
- Supports most used models
- Short down-time (OFF-operation) period
- Proved and tested system
- Easy and accurate reading of engine fuel consumption
- No extra maintenance necessary
- Tamper-proof measurement

## Your benefits

- Low installation costs
- Quick and easy installation
- Short down-time of vehicle
- Quick pay-back period

# The right product for every application

Suitable for trucks, buses, agricultural and construction vehicles, small river boats

## CONTOIL® VZD / VZP System



### Flow meters for direct fuel measurement

#### Suitable for small engines

##### CONTOIL® VZD 4

The easy way to find your fuel consumption. Just install it and read the values on the display (total, trip, current consumption and more).

##### CONTOIL® VZP 4

If the installation place is hidden and a read-out on the flow meter not possible, than this flow meter is the right one. Connect it to the CONTOIL® VZD CU and you will have all the necessary information wherever you want it.

#### Suitable for large engines

##### CONTOIL® VZD 8

An easy way to find your fuel consumption. At a glance, you have the following information: total, trip, actual fuel consumption and much more. With its digital output, the results can be transferred to a remote host.

##### CONTOIL® VZP 8

For installation places where the read-out is not easy, choose this flow meter. The built-in LED gives you the function status at any time. The VZD CU is recommended for fuel calculation. Connection to a remote calculator is possible (eg. fleet manager).

#### Suitable for remote control

##### CONTOIL® VZD CU

Remote calculator for the VZD/VZP series. Install the VZD Control Unit in the driver cabin and you have all the necessary information about fuel consumption every time. Flow meters from competitors can be connected.

Page 5

## CONTOIL® DFM System



### Flow meters for differential fuel measurement

#### Suitable for small engines

##### CONTOIL® DFM 8D

- Compact 2-chamber system
- Space-saving design
- Built for extreme environments



**Suitable for large engines**

**CONTOIL® DFM 20S / CONTOIL® DFM 25S**

- Compact 1-chamber system (2 pieces needed for differential measurement)
- Built for extreme environments
- Suitable for big agricultural and construction vehicles, big river boats, small vessels



**Suitable for calculation and data-sending to remote**

**CONTOIL® DFM-BC (board computer)**

- Suitable for all DFM flow meters and other manufacturers' flow meters
- Total, trip, current consumption, info, service (password-protected)
- Configurable input-pulse value (0.1 ml to 9.9 litre)

**Page 8**

**CONTOIL®  
DFM 8EDM**



**Flow meter for fleet manager DFM System**

**CONTOIL® DFM 8EDM**

Easy-to-install flow meter – just connect the pipes and the three electrical wires.  
The calculated consumption will be sent as a passive pulse and a TTL pulse

**Page 12**

**CONTOIL®  
DFM 8ECO**



**CONTOIL® DFM 8ECO**

- Newest Reed-Contact-Technology
- Easy installation
- Rugged design

**Page 14**

**CONTOIL®  
DFM 12ECO**



**CONTOIL® DFM 12ECO**

- Build up for heavy-duty engines
- New design of the fluid flow
- Up to 600 l/h flow

**Page 16**

**Additional information**

**Page 18**

**Your savings**

**Page 20**

# How to measure fuel

Two systems are on the market...

- **Direct consumption**

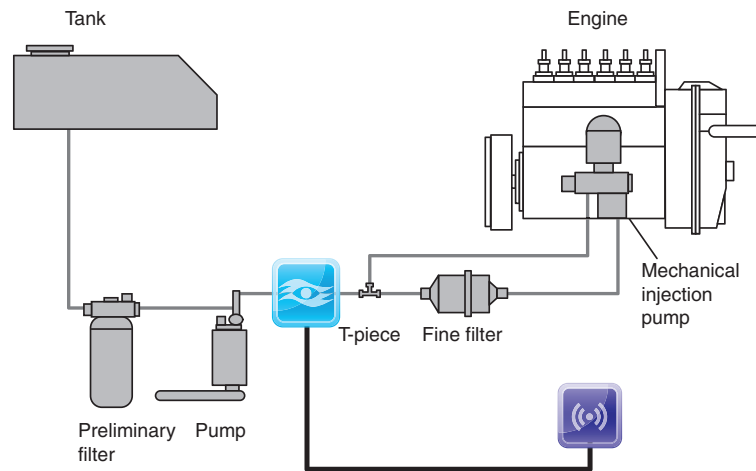

With this variant, the fuel is sucked out of the tank by the pump and through the preliminary filter, then fed through the fine filter to the mechanical injection pump. Depending on the engine conditions, the injection pump measures the fuel to be injected and forwards it to the individual cylinders. There, the fuel is injected into the combustion chamber by the injection nozzles. The unused fuel is not feeded back to the tank through a separate line, but is fed back into the fuel line after the pump and before the fine filter in order to filter out any mechanical impurities. In this variant, the pump supplies the amount of fuel required by the engine, depending on its operating mode. The pump supply is controlled by the pressure after the pump.

- **Differential consumption**

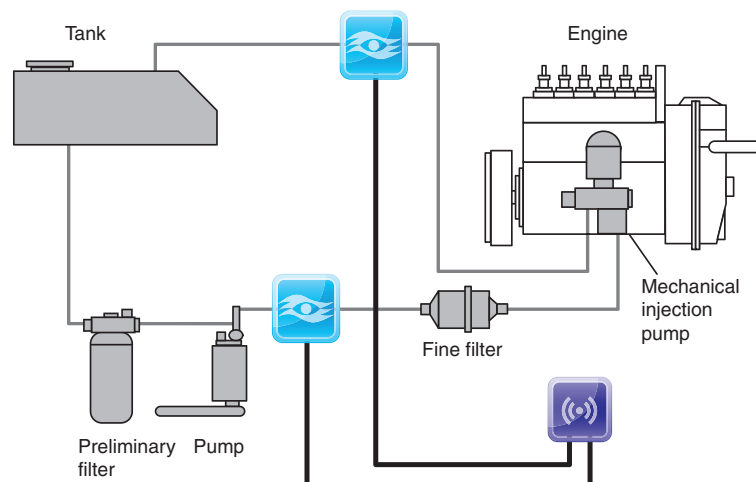

With this variant, the fuel is sucked out of the tank by the pump and through the preliminary filter, then fed through the fine filter to the mechanical injection pump. Depending on the engine conditions, the injection pump measures the fuel to be injected and forwards it to the individual cylinders. There, the fuel is injected into the combustion chamber by the injection nozzles. The pump's job is to provide 4 to 10 times the amount of fuel that could possibly be used (e.g. for a maximum consumption of 50 l/h, the pump should be able to supply 200 l/h to 500 l/h). This quantity depends on the engine and the manufacturer; the above figures are just guidelines. The unused fuel is returned back to the tank through a separate line. This is the standard in modern engines (common rail, etc.).

... and we offer and support both of them.

# CONTOIL® VZD/VZP System

CONTOIL® VZD with digital display shows you all information at a glance



- Total fuel consumption (litre, gal. or kg/m3)
- Correction factor (eg. temperature compensation)
- Daily fuel consumption (litre, gal. or kg/m3)
- Idle time of the engine
- Current consumption (litre, gal. or kg/m3)
- Working time of the engine
- Fuel temperature
- CO<sub>2</sub> measurement (actual and total)

## Technical data

- Safety  
Tested for vibration, shock and electrical emission and immission (vehicle industry standards)
- Operation temperature of the hydraulic: -30°C to +80°C
- Diesel fuel, domestic fuel oil, engine oil (viscosity max. 6 cSt)

## Hydraulic specifications

Device	VZD 4	VZP 4	VZD 8	VZP 8	VZD CU
Part number	94679	94681	94680	94682	94706
Hydraulic connection	M14x1.5	M14x1.5	M14x1.5	M14x1.5	n.a.
Nominal pressure	25	25	25	25	n.a.
Temperature display (°C)	-20 to +60	n.a.	-20 to +60	n.a.	-20 to +60
Protection class (IP)	66	66	66	66	66
Max. flow rate (l/h)	80	80	200	200	n.a.
Nominal flow rate (l/h)	50	50	135	135	n.a.
Min. flow rate (l/h)	1	1	4	4	n.a.
Accuracy (%) better than	1	1	1	1	n.a.
Repeatability (%)	+/- 0.2	+/- 0.2	+/- 0.2	+/- 0.2	n.a.
Registration capacity	99999999	n.a.	99999999	n.a.	99999999
Safety filter mesh size (mm)	0.125	0.125	0.150	0.150	n.a.
Volume of measuring chamber (ml)	5.0	5.0	12.44	12.44	n.a.
Battery	Yes	No	Yes	No	Yes

## Electrical specifications

Device	VZD 4	VZP 4	VZD 8	VZP 8	VZD CU
Max. frequency of input-pulse	n.a.	n.a.	n.a.	n.a.	13Hz
Pulse OUT (HI-Res) width	20ms	20ms	20ms	20ms	n.a.
Pulse OUT (Param) width	1000ms	n.a.	1000ms	n.a.	1000ms
Current load (open drain output) max.	50mA	50mA	50mA	50mA	50mA
Output operational voltage max.	48VDC	48VDC	48VDC	48VDC	48VDC
Amplitude range	Equale to power supply				

n.a. = not available

CONTOIL® VZP 4/8

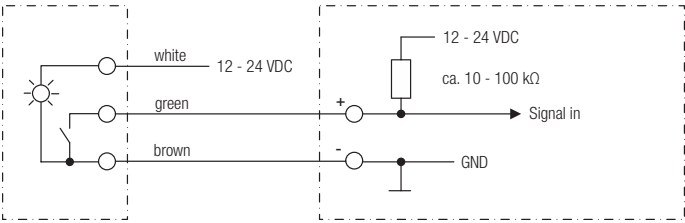

Output Signal Specification

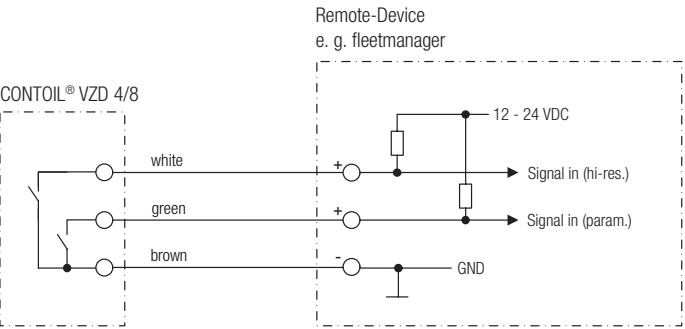
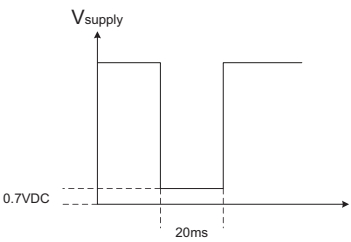

Short view of the CONTOIL® VZD 4 and VZD 8 menu

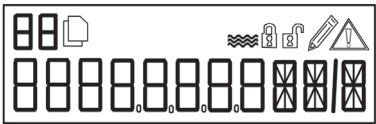

Main menu

- Total, trip, current consumption
- Info, service
- Logger data, error data, display test

Info/service menu

- Idle/working mode, operation hours, unit
- Battery capacity, fuel temperature, RESET mode
- Correction factor, password
- Current CO<sub>2</sub> emission, total CO<sub>2</sub> emission
- Min. flow rate, max. flow rate
- Date, time

The complete menu is shown in the Operating Manual

Materials

Table of materials used

Parts	Materials
Housing/measuring unit	Brass
Seals	NBR butadiene-acrylonitril
Rotary piston	Anodised aluminium

## Dimensions

CONTOIL® VZD 4 und VZP 4

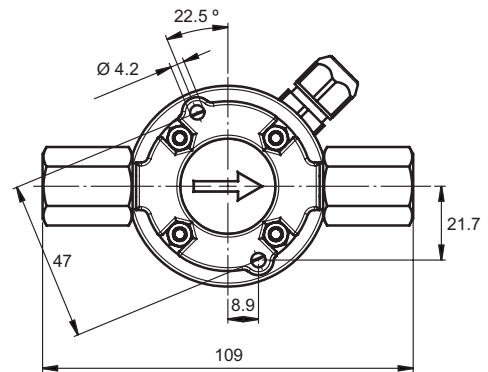
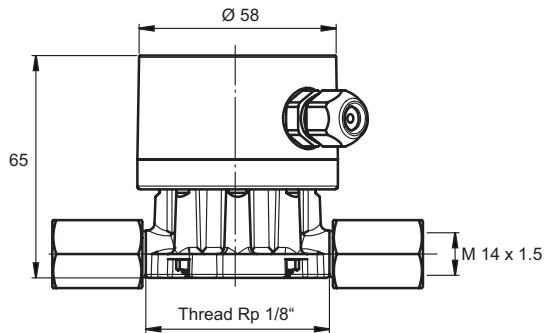

CONTOIL® VZD 8 und VZP 8

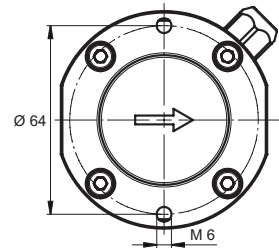
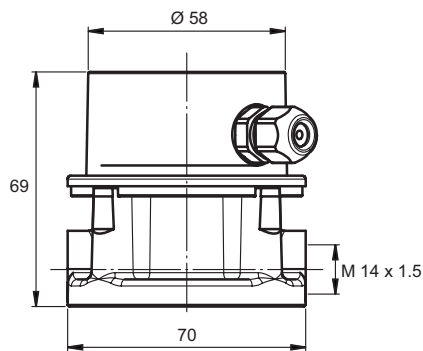

CONTOIL® VZD CU

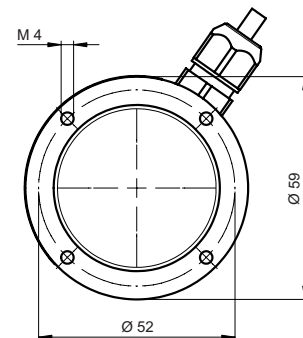
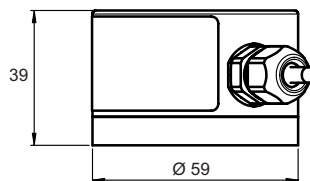

## Accessories

Table of materials used

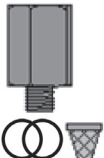
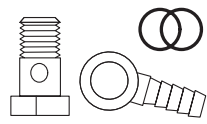
	Description		Quantity	Part number
	<b>Gasket for VZD/VZP 4</b>	FKM	1	19912
	<b>Gasket for VZD/VZP 8</b>	FKM	1	11357
	<b>Modification kit</b>	VSR-SET VZD/VZP 4 1/8" to M14x1.5	1 *)	80630
	<b>Threaded connections</b>	PS-Satz DFM and VZD/VZP	1 *)	80447

\*) 2 sets needed for one flow meter.

# CONTOIL® DFM System

**With the DFM-BC (board computer), you have all the information at a glance**



- Total fuel consumption
- Daily fuel consumption
- Current consumption
- Info mode
- Service mode
- Status of the supply or return line
- Correction factor (eg. temperature compensation)
- Configuration log
- Error log

## Technical data

- Safety  
Tested for vibration, shock and electrical emission and immission (vehicle industry standards)
- Operation temperature of the hydraulic: -30°C to +80°C
- Diesel fuel, domestic fuel oil, engine oil (viscosity max. 6 cSt)

## Hydraulic specifications

Device	DFM 8D	DFM 20S	DFM 25S
Part number	94465	94466	94467
Hydraulic connection	M14x1.5	G1"	G1 ¼ "
Nominal pressure	16	16	16
Temperature (°C)	-30 to +80	-30 to +80	-30 to +80
Temperature display (°C)	-20 to +60	-20 to +60	-20 to +60
Protection class (IP)	66	66	66
Nominal flow rate (l/h)	200	1000	2000
Min. flow rate (l/h)	10	100	200
Accuracy (%) better than	1	1	1
Repeatability (%)	+/- 0.2	+/- 0.2	+/- 0.2
Safety filter mesh size (mm)	N.A	0.400	0.400
Volume of measuring chamber (ml)	12.44	36	100

## Electrical specifications

Flow sensor	l/pulse (ml/pulse)	Hz (max.)	Pulse interval (min.)	Pulse width	mA (max.)	VDC (nominal)
Double sensor DFM 8D	0.01244 (12.44)	15	46	20 ms	10	12-24
Single sensor DFM 20S	0.036 (36)	15	46	20 ms	10	12-24
Single sensor DFM 25S	0.100 (100)	15	46	20 ms	10	12-24
Amplitude range	Equal to power supply					

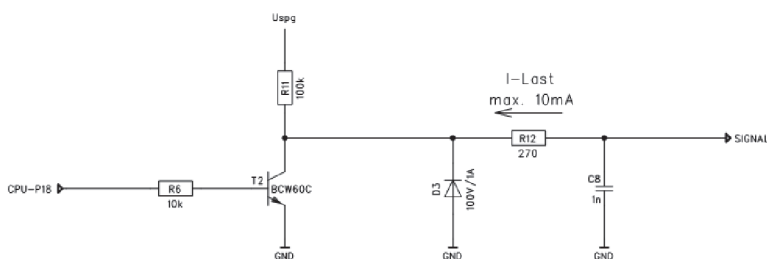

### Output Signal Specification

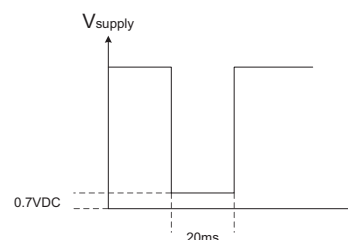



## CONTOIL® DFM-BC specifications



- Safety  
Tested for vibration, shock and electrical emission and immission (vehicle industry standards)
- Operation temperature of the hydraulic: -10°C to +70°C
- Diesel fuel, domestic fuel oil, engine oil (viscosity max. 6 cSt)
- 3" graphic display
- 4 navigation keys

### Further specifications

Device	DFM-BC
Part number	94476
Registration (in litre)	100.000.000
Input (flow meter connections), adjustable from 0.1 ml to 9999.9ml	2
Output (for remote device) adjustable from 0.1 ml to 9999.9ml	1
Temperature (°C)	-10 to +70
Data storage	EEPROM
Online status of the connected flow meters	Yes
Protection class (IP)	IP66

### Electrical specifications

Max. frequency of input/output pulses	25Hz.
Cable lengths	7.5m
Power supply (direct from the vehicle battery)	12VDC to 24VDC
Power supply cable	2x 0.75mm <sup>2</sup>
Current load (pulse in/pulse out; open drain output) max.	15mA
Pulse width (pulse in/pulse out) min	20ms
Output operational voltage max.	48VDC

### Materials

Table of materials used for the flow meters

Parts	Material	DFM 8D, DFM 8EDM, DFM 8ECO, DFM 12ECO	DFM 20S, DFM 25S
Housing/measuring chamber	Brass	•	
	Cast brass		•
Measuring chamber	Cast brass		•
Seals	FPM fluorelastomer	•	•
Rotary piston	Anodised aluminium	•	•

## Dimensions

CONTOIL® DFM 8D, DFM 8EDM, DFM 8ECO, DFM 12ECO

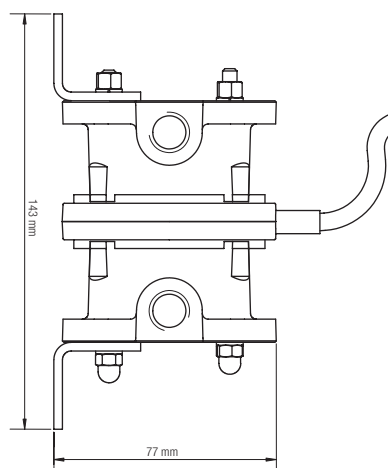
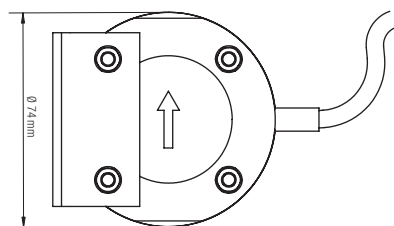

CONTOIL® DFM 20S and DFM 25S

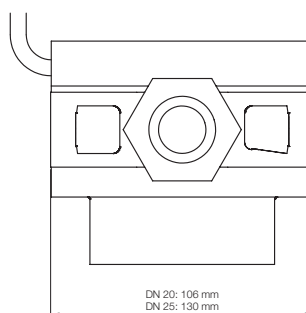
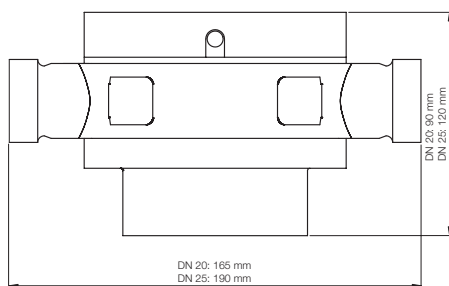

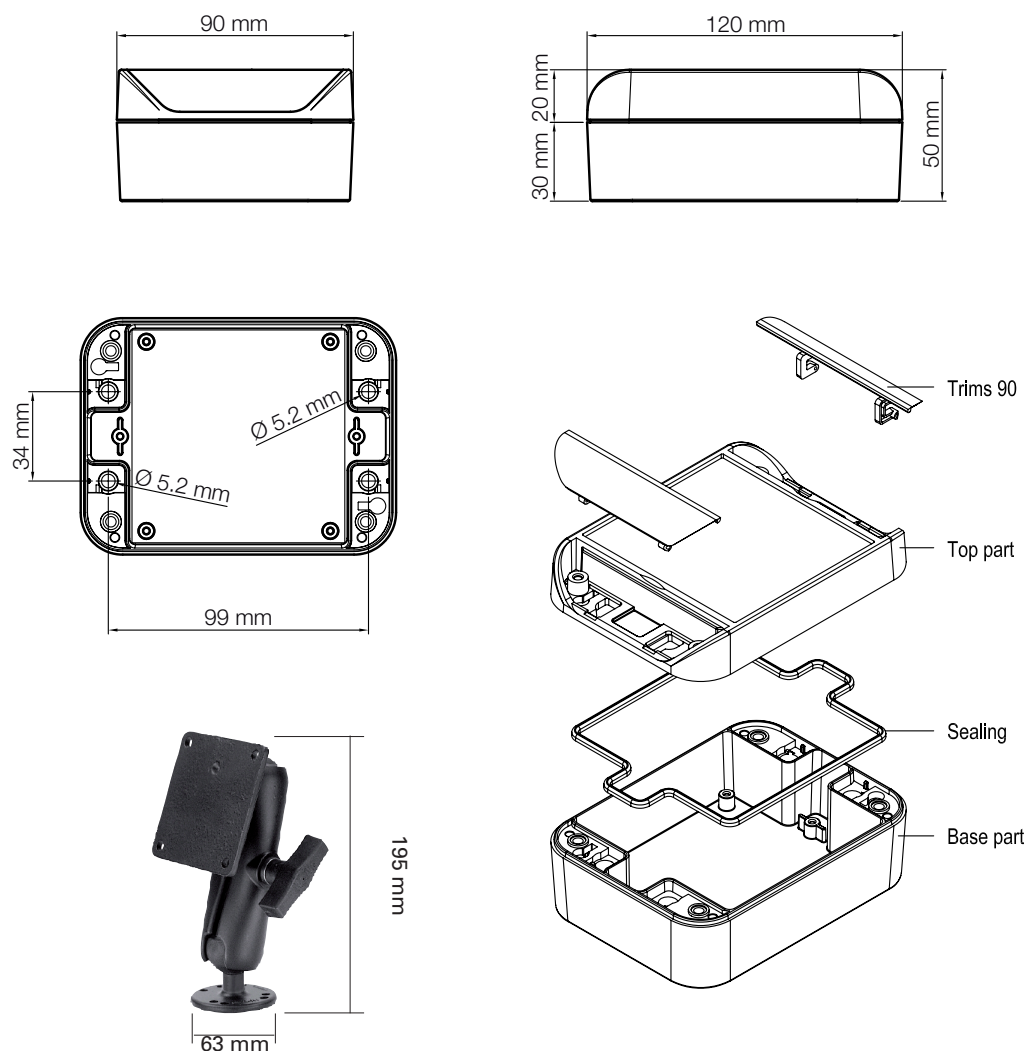

## Accessories

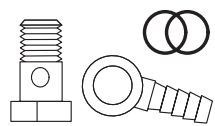
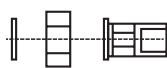
	Description		Quantity	Part number
	<b>Mounting bracket DFM-BC</b>	DFM-MB	1	80485
	<b>Hose connector for DFM 8xxx</b> include 1x hollow union, 1 single banjo body, 1x copper seal	DFM 8D, DFM 8EDM, DFM 8ECO DFM12ECO	1 *)	80447
	<b>Pipe connector for DFM 20S</b>	VSR ¾ "	1 **)	81166
	<b>Pipe connector for DFM 25S</b>	VSR 1 "	1 **)	81169

\*) 4 sets needed for one DFM 8D, DFM 8EDM, DFM 8ECO, DFM12ECO.

\*\*) 2 sets needed for one flow meter.

# CONTOIL® DFM 8EDM

## With integrated differential measurement



- Optimal design for fleet manager owner
- Integrated intelligence
- Passive pulse output
- TTL pulse output
- Compact 2-chamber system
- Space-saving design
- Built for extreme environments

## Technical data

- Safety  
Tested for vibration, shock and electrical emission and immission (vehicle industry standards)
- Operation temperature of the hydraulic: -30°C to +80°C
- Diesel fuel, domestic fuel oil, engine oil (viscosity max. 6 cSt)

## Flow meter specifications

Device	DFM 8EDM
Part number	94954
Hydraulic connection	M14x1.5
Nominal pressure	16
Protection class (IP)	66
Nominal flow rate (l/h)	200
Min. flow rate (l/h)	10
Accuracy (%) better than	1
Repeatability (%)	+/- 0.2
Safety filter mesh size (mm)	N.A
Volume of measuring chamber (ml)	12.44

## Electrical specifications

Flow sensor	l/pulse (ml/pulse)	Hz (max.)	Pulse interval (min.)	Pulse width	mA (max.)	VDC (range)	Amplitude (range)
Double sensor DFM 8EDM	0.01244 (12.44)	7	46	20 ms	10	12-24	Equal to power supply

## Pulse specification

Passive Pulse

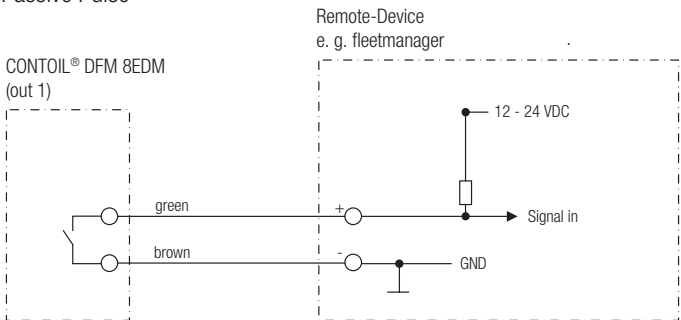

Whenever a pulse is generated, the electronic switch at the DFM 8EDM will be closed and the incoming 12-24VDC will be redirected to the external device.

## TTL-Pulse

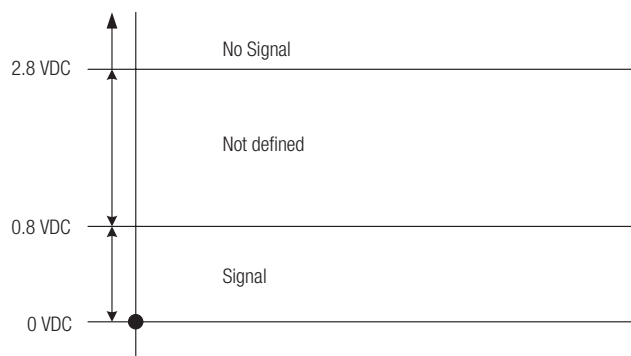

Below 0.8 VDC = pulse (logic 0)  
 Between 0.8 – 2.8 VDC is not defined  
 Over 2.8 VDC = no pulse (logic 1)

## Materials

Table of materials used for the flow meters

Parts	Material
Housing/measuring chamber	Brass
Seals	FPM fluorelastomer
Rotary piston	Anodised aluminium

## Dimensions

CONTOIL® DFM 8EDM

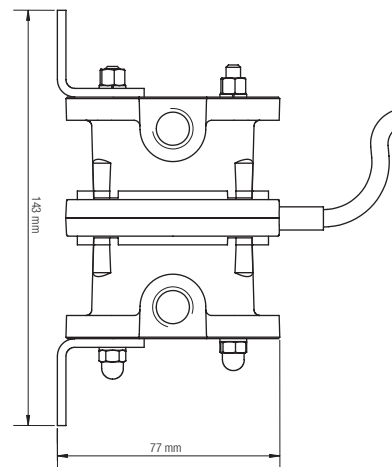
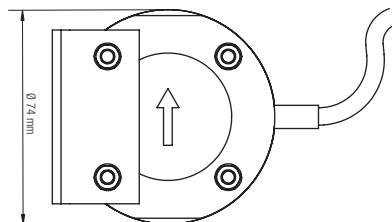

## Accessories

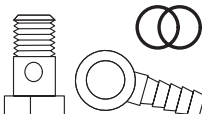
	Description	Quantity	Part number
	<b>Hose connector for DFM 8xxx</b> include 1x hollow union, 1 single banjo body, 1x copper seal	1 *)	80447

\*) 4 sets needed for DFM 8EDM.

# CONTOIL® DFM 8ECO

## With new integrated reed-contact technology for differential measurement

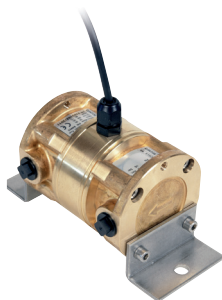

- Optimal designed for Fleet Manager Owner
- New integrated reed-pulse technology
- Passive pulse output
- Compact 2-Chamber system
- Space saving design
- Build for extreme environments

## Technical data

- Safety  
Tested for vibration, shock and electrical emission and immission (vehicle industry standards)
- Operation temperature of the hydraulic: -30°C to +80°C
- Diesel fuel, domestic fuel oil, engine oil (viscosity max. 6 cSt)

## Flow meter specifications

Device	DFM 8ECO
Part number	94953
Hydraulic connection	M14x1.5
Nominal pressure	16
Protection class (IP)	66
Nominal flow rate (l/h)	200
Min. flow rate (l/h)	10
Accuracy (%) better than	1
Repeatability (%)	+/- 0.2
Safety filter mesh size (mm)	N.A
Volume of measuring chamber (ml)	12.44

## Electrical specifications

Flow sensor	l/pulse (ml/pulse)	Hz (max.)	Pulse interval (min.)	Pulse width	mA (max.)	VDC * (range)	Amplitude (range)
Double sensor DFM 8ECO	0.01244 (12.44)	7	46	20 ms	10	12-24	Equal to power supply

\* This value is related to the ISO/DIS 16750-2

## Pulse specification

Passive Pulse

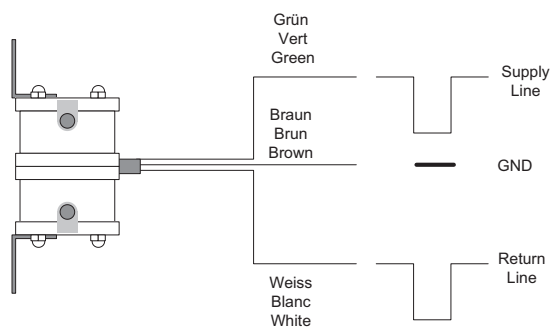

## Output Signal Specification

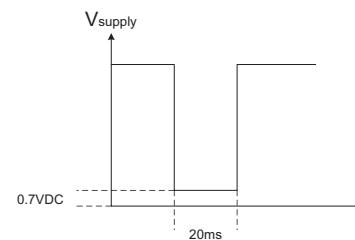

Whenever a pulse is generated, the electronic switch at the DFM 8ECO will be closed and the incoming 12-24VDC will be redirected to the external device.

## Materials

Table of used materials for the flow meters

Parts	Materials
Housing/measuring unit	Brass
Seals	NBR butadiene-acrylonitril
Rotary piston	Anodised aluminium

## Dimensions

CONTOIL® DFM 8ECO

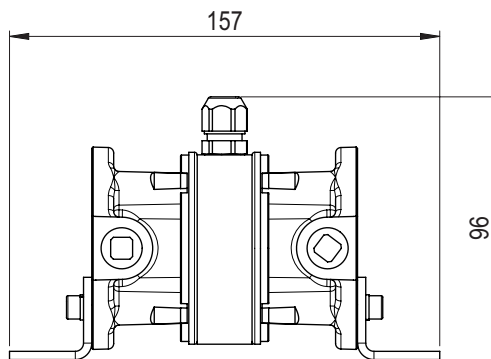
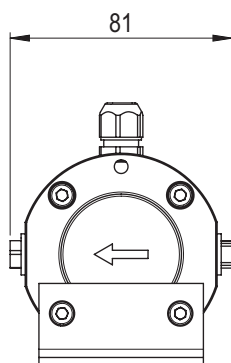

## Accessories

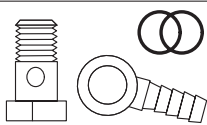
	Description	Quantity	Part number
	<b>Hose connector for DFM 8xxx</b> include 1x hollow union, 1 single banjo body, 1x copper seal	1 *)	80447

\*) 4 sets needed for DFM 8ECO.

# CONTOIL® DFM 12ECO

With new integrated reed-contact technology for differential measurement

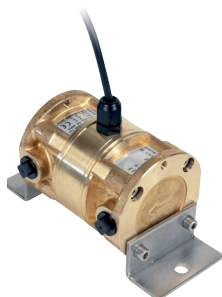

- **New:** improved hydraulic design allows higher flows
- **New:** integrated reed-pulse technology
- Passive pulse output
- Compact 2-Chamber system
- Space saving design
- Build for extreme environments

## Technical data

- Safety  
Tested for vibration, shock and electrical emission and immission (vehicle industry standards)
- Operation temperature of the hydraulic: -30°C to +80°C
- Diesel fuel, domestic fuel oil, engine oil (viscosity max. 6 cSt)

## Flow meter specifications

Device	DFM 12ECO
Part number	95286
Hydraulic connection	M14x1.5
Nominal pressure	16
Protection class (IP)	66
Qmax (l/h)	600
Qmin (l/h)	10
Tests	EMC, Shock, Vibration (4g)
Accuracy (%) better than	1
Repeatability (%)	+/- 0.2
Safety filter mesh size (mm)	0.150
Volume of measuring chamber (ml)	12.44

Flow sensor	l/pulse (ml/pulse)	Hz (max.)	Pulse interval (min.)	Pulse width	mA (max.)	VDC * (range)	Amplitude (range)
Double sensor DFM 12ECO	0.01244 (12.44)	14	46 ms	20 ms	10	12-24	Equal to power supply

## Electrical specifications

\* This value is related to the ISO/DIS 16750-2



## Pulse specification

Passive Pulse

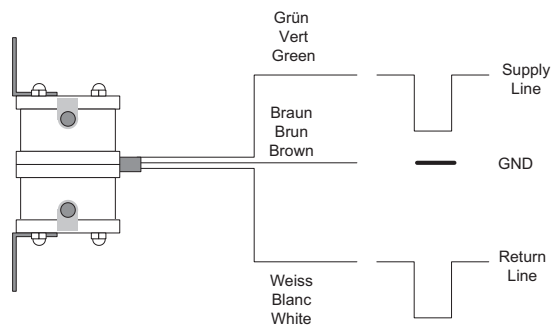

## Output Signal Specification

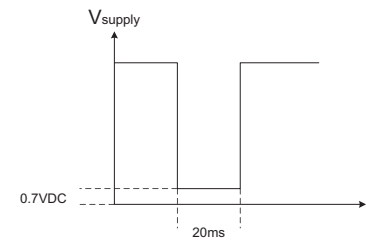

Whenever a pulse is generated, the electronic switch at the DFM 12ECO will be closed and the incoming 12-24VDC will be redirected to the external device.

## Materials

Table of used materials for the flow meters

Parts	Materials
Housing/measuring unit	Brass
Seals	NBR butadiene-acrynitril
Rotary piston	Anodised aluminium

## Dimensions

CONTOIL® DFM 12ECO

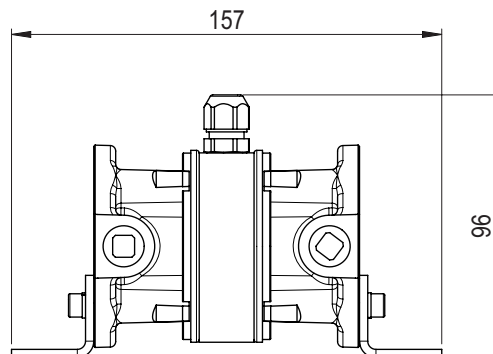
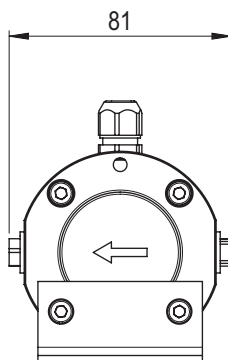

## Accessories

	Description	Quantity	Part number
	<b>Hose connector for DFM 8xxx</b> include 1x hollow union, 1 single banjo body, 1x copper seal	1 *)	80447

\*) 4 sets needed for DFM 12ECO.

## Additional Information

### Fuel Oil

Our fuel flow meters are manufactured to run according to the fuel oil specification in the norm ISO 8217-2010. This norm specifies the characteristics of the fuel. Fuel oil with **low sulphur** can be used if it follows the rules specified in the mentioned norm.

A few parameters from this norm are listed in the table below.

### Characteristics of different fuels

Fuel			Diesel *)	MGO 2 **)	MDO 2 **)
Density at 15°C	min.	Kg/l	0.820		
	max.	Kg/l	0.845		
Viscosity at 40°C		mPa.s	1.5 – 4.5	2-6	2-11
Lubricity value (HFRR)	max.	µm	470	520	520
Sulphur ***)	max.	%m/m		1.50	2.00

\*) Diesel, diesel oil or AGO (Automotive GasOil) are the same

\*\*) Also used for river boats

\*\*\*)Max. value – normally, the value is much lower

### Pressure drop curves

#### Viscosity information

Kinematic viscosity	Stokes, Centi-Stokes, mm <sup>2</sup> /s	St, cSt, mm <sup>2</sup> /s
Dynamic viscosity	Pascal seconds, millipascal seconds	Pas, mPa.s
	Poise, Centipoise (outmoded)	P, cP

Conversion	cSt 3 density = mPa.s
	Engler degrees °E to mPa.s: only use conversion table
	Saybolt units to mPa.s: only use conversion table
	Redwood units to mPa.s: only use conversion table

Rule of thumb	1 cSt ~ 1 mm <sup>2</sup> /s ~ 1 mPa.s
---------------	--

## CONTOIL® VZD 4, VZP 4

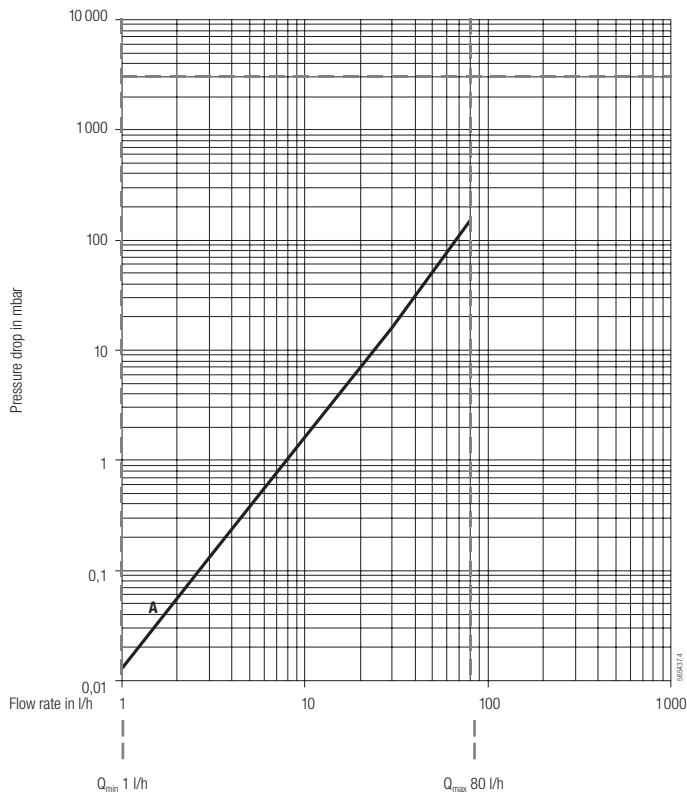

## CONTOIL® VZD 8, VZP 8, DFM 8D, DFM 8EDM, DFM 8ECO, DFM 12ECO

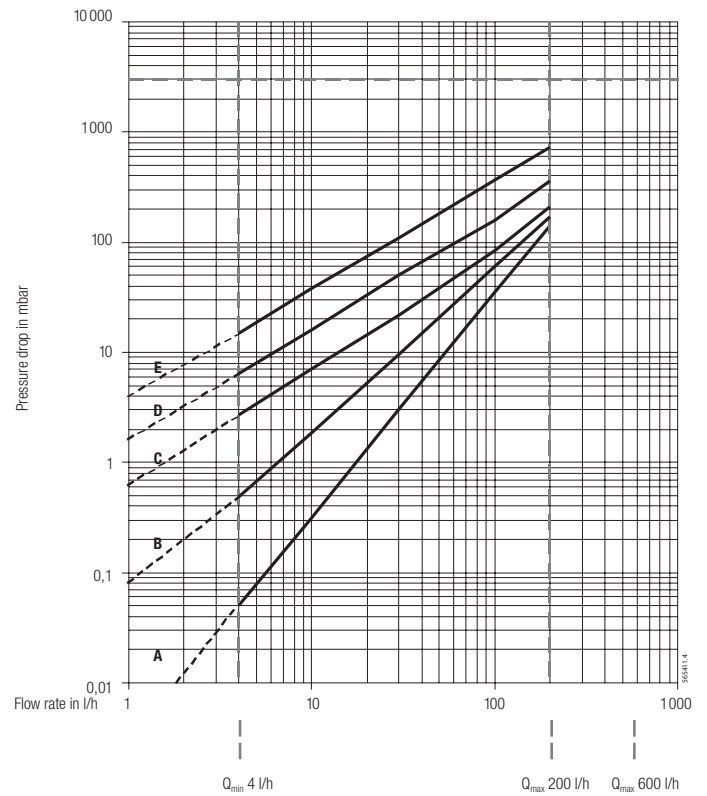

## CONTOIL® DFM 20S

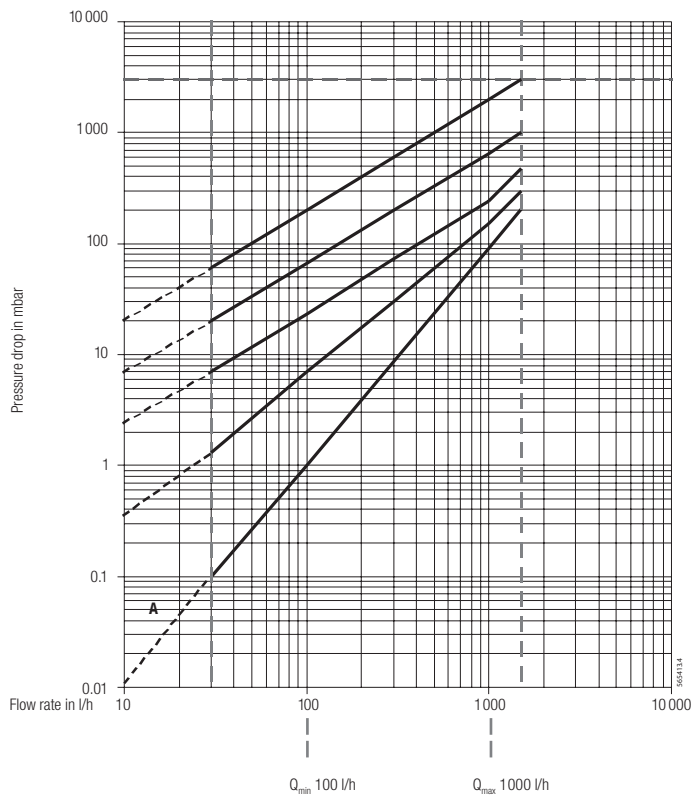

## CONTOIL® DFM 25S

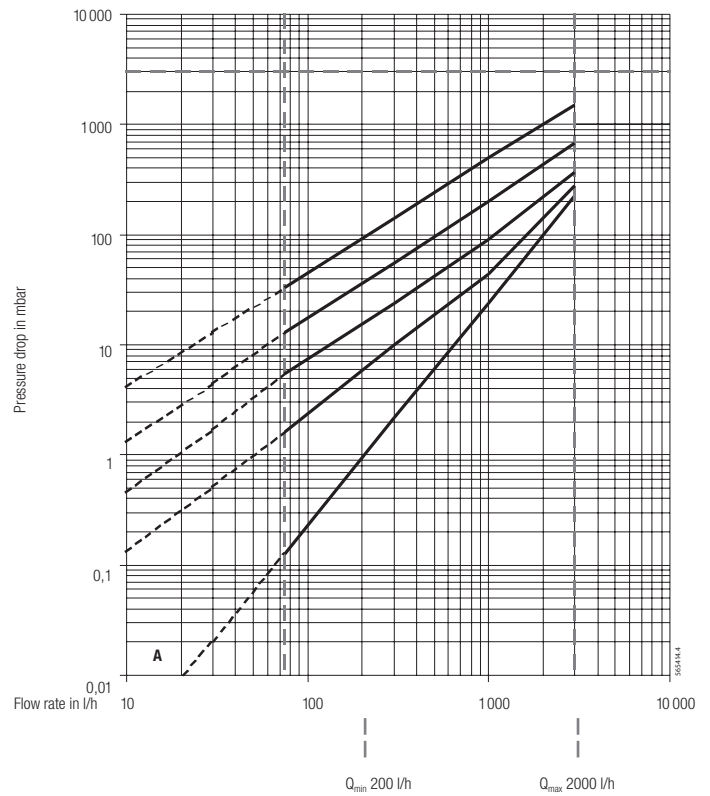

Viscosity diagrams:

A = 5 mPa.s  
B = 50 mPa.s

C = 100 mPa.s  
D = 200 mPa.s

E = 500 mPa.s

For a pressure drop of more than 1 bar, it is recommended to use the next larger meter size.

Maximum permissible pressure drop = 3 bar

# Your savings

## Example for trucks

Below are examples on how easy it is to calculate what this system is worth to you:

### Operating data of vehicle (examples)

Km per day	200	200	<b>500</b>	750
Consumption in litres per 100 km	30	30	<b>30</b>	30
Operation days per year	250	250	<b>250</b>	250
Operation km per year	50'000	50'000	<b>125'000</b>	187'000
Operation liters per year	15'000	15'000	<b>37'500</b>	56'250
<b>Influence of fuel price</b>				
Fuel price per litre in euros (assumption) <sup>1)</sup>	1.36	1.36	1.36	1.36
Fuel cost per year in euros	20'400	20'400	<b>51'000</b>	76'500
<b>Return on Investment</b>				
Complete investment cost in euros (example) <sup>2)</sup>	1'400	1'400	<b>1'400</b>	1'400
Estimated reduction of fuel cost in %	20	15	<b>10</b>	5
Savings of fuel cost per year in euros	4'080	3'060	<b>5'100</b>	3'825
Pay-back time in months	4	5	<b>3</b>	4
Money saved in the first 12 months	2'680	1'660	<b>3'700</b>	2'425

1) Average price of diesel fuel in Europe

2) DFM 8D used for this example. Complete investment cost may vary from country to country due to local situations.

Includes flow sensors, board computer, all transport and import costs, installation and start-up of system.

Take the example from the third column: with the above vehicle operating data and 10% estimated reduction of fuel cost, the investment will pay back its costs after only three months. Since the figures are different in each area, they have to be adapted to individual values. Ask your authorised dealer for a personal assessment. He will calculate your possible cost savings based on your vehicle data, operating conditions and the local cost situation.

<b>SWITZERLAND:</b>	<b>Aquametro AG, CH-4106 Therwil</b> Aquametro SA, CH-1800 Vevey Aquametro AG, CH-6929 Gravesano bill24 AG, CH-8306 Brüttisellen	<b>info@aquametro.com</b> info@aquametro.com info@aquametro.com info@bill24.ch	<b>www.aquametro.com</b> www.aquametro.com www.aquametro.com www.bill24.ch
<b>BELGIUM:</b>	Aquametro Belgium SPRL, B-1933 Sterrebeek	info.amb@aquametro.com	www.aquametro.be
<b>CHINA:</b>	Aquametro (S.E.A.) Pte Ltd., Singapore 757516	info.china@aquametro.com	www.aquametro.com
<b>GERMANY:</b>	Aquametro Messtechnik GmbH, D-28329 Bremen Aquametro Marine GmbH, D-18119 Rostock-Warnemünde	info.amd@aquametro.com info.amd-marine@aquametro.com	www.aquametro.de www.aquametro.de
<b>INDIA:</b>	Aquametro Representative Office, Mumbai 400053	info.india@aquametro.com	www.aquametro.in
<b>JAPAN:</b>	Aquametro Representative Office, Tokyo 152-0031	info.japan@aquametro.com	www.aquametro.jp
<b>KOREA:</b>	Aquametro Korea Ltd., Busan 612-857	info.korea@aquametro.com	www.aquametro.kr
<b>SINGAPORE:</b>	Aquametro (S.E.A.) Pte Ltd., Singapore 757516	info.singapore@aquametro.com	www.aquametro.sg
<b>UAE:</b>	Aquametro ME JLT, Dubai / UAE	info.dubai@aquametro.com	www.aquametro.ae